

CREVERSE

GLOBAL MARKETING GROUP

CREVERSE

GLOBAL MARKETING GROUP

THE INFORMATION IN THIS DOCUMENT IS CONFIDENTIAL AND PROPRIETARY AND OWNED BY CREVERSE GLOBAL MARKETING GROUP FOR THE SOLE USE OF THE INTENDED RECIPIENT(S). NO PORTION OF THIS DOCUMENT MAY BE REPRODUCED, REDISTRIBUTED, OR OTHERWISE DISCLOSED TO ANY THIRD PARTY WITHOUT CREVERSE GMG WRITTEN PERMISSION.

WHAT'S CREVERSE?

CREATIVE
MULTIVERSE



We help you leave a positive impact by incorporating Saudi Vision 2030 goals in everything we do for you.

VISION

Elevating brands presence by redefining creativity and innovation in marketing and communication.

VISION
MISSION

MISSION

Staying ahead of the game by adapting the latest technologies and trends, by focusing on making impact on businesses ROI.

WE'RE GLOBAL
WE'RE GLOBAL
WE'RE GLOBAL

EVERYTHING IS POSSIBLE
WITH OUR WORLDWIDE NETWORK.

We truly believe in a world of endless possibilities, where every experience you imagine can come to life – no matter what its, get exclusive and easy access to our specialized partners worldwide.



WE'RE GLOBAL

MILESTONE

JAN 2021

Started as a marketing department for Omar Alesayi Holding & its subsidiaries

MAY 2022

Founded as an independent 360 marketing agency – CREVERSE

FEB 2023

Became a marketing group providing a variety of specialized services

AUG 2021

Established our own production facility in Jeddah

NOV 2022

Expanded our production house to become one of the largest production house locally.

JUN 2023

Became an international marketing group CREVERSE GMG

OUR APPROACH



BRING
YOUR STORY
TO LIFE
IN **THE MOST** IMPACTFUL WAY

- INSPIRING CREATIVITY
- DESIGNING STRATEGIES
- DRIVING INNOVATION
- UTILIZING TECHNOLOGY
- CREATING IMPACT

DISCOVER
OUR ESSENCE

As a premier full-service marketing group with a vast global network, we at CREVERSE GLOBAL MARKETING GROUP are renowned for making anything possible. We proudly own one of Saudi Arabia's largest production houses and bring extensive expertise across diverse sectors:

- AUTOMOTIVE**
- REAL ESTATE**
- FACILITY MANAGEMENT**
- HOSPITALITY**
- FMCG**
- MEGA EVENT**
- F&B**
- FINANCIAL SOLUTIONS**
- INSURANCE**
- INFORMATION TECHNOLOGY**
- HOLDING GROUP**
- ENTERTAINMENT**

As a 360 marketing group, we offer a wide range of services to meet all your needs, from Branding and communication to production such as Booths & POS materials, media and technology, and even events and entertainment.



شركة مجموعة عمر قاسم العيسائي القابضة
OMAR KASSEM ALESAYI HOLDING GROUP

ENGINEERING
& TECHNOLOGY



REAL ESTATE
& ASSET MANAGEMENT



CONSUMER
& TRADING



ELECTRONICS



FACILITY
MANAGEMENT
& MANPOWER



MARKETING
& PRODUCTION



FINANCIAL



CREVERSE

GLOBAL MARKETING GROUP

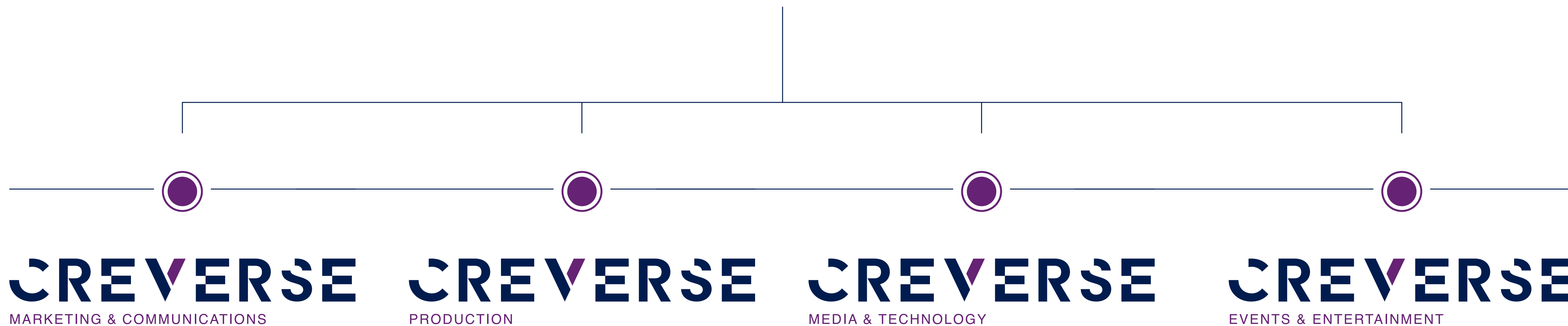



MARKETING & COMMUNICATION

- Branding & Brand Development (Brand Identity, Brand Guidelines, Brand Strategy, and Brand Communications)
- Digital Marketing & Social Media
- PR & Corporate Communications
- Advertising & Activation
- Content Marketing

PRODUCTION & PRINTING

- Signages
- Installations
- POS Material
- Interior Design
- Booths & Stages
- wayfinding system
- Indoor/Outdoor Printings



MEDIA & TECHNOLOGY

- **Technology**

Audio, Video, Laser, Drone Show, Projection Mapping, Hologram, AR, VR, and Immersive System.

- **Media Production**

Photography, Videography, and drone.

- **Post Production**

2D Explainer Video, 3D Animation Services , Whiteboard Animation, Overview Video, and Showreel Video, Voiceover & Music.

EVENTS & ENTERTAINMENT

- Ideation
- Planning
- Theming
- Sponsorships
- Management & Execution

PLANNING & THEMING 01

06 TICKETING SYSTEM

VENUE BOOKING
CREATION 02

07 SPONSORSHIP SERVICES

PRINTING &
PRODUCTION 03

08 RENTAL SERVICES

MEDIA SERVICES 04

09 MANPOWER SERVICES

ENTERTAINMENT &
ACTIVATION 05

10 MARKETING &
ADVERTISING SERVICES

ECO
EVENT
SYSTEM

WHY US?

- EXCLUSIVE GLOBAL PARTNERS
- A VARIETY OF SERVICES FOR ALL YOUR NEEDS
- EXPERIENCE IN DIVERSE SECTORS
- ACCESS TO ALESAYI SISTER COMPANIES
- ONE OF THE LARGEST PRODUCTION FACILITY IN SAUDI ARABIA

TRUSTED BY THE ELITE

With over +700 projects accomplished for our elite partners, we would be honored to include you in this distinguished collection.



LIVE THE EXPERIMENT

Taking action to inspire change is what we
excel at – **HERE'S HOW WE DID IT**





BRANDING

نما كابيتال NAMA CAPITAL

NAMA Capital is an asset management company focused on real estate investments. We aim to create investment opportunities that provide attractive returns to our investors while enriching the communities we serve.

STORM
GREY

DUSKY
BLUE

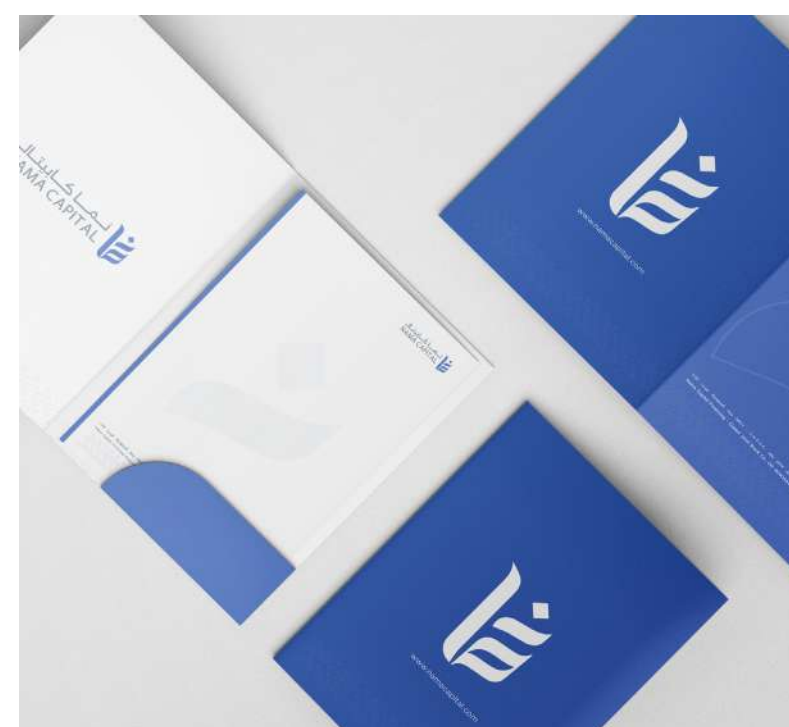

BRAND ICON



A B R A J O M A R

BRAND
WORDMARK

HOTEL & RESIDENCE

BRAND TAGLINE



5359U



CREVERSE

We propose a simple yet impactful logo for LLC - Alesayi Holding, an electronic games company specializing in distributing Nintendo devices in the UAE. The logo will be used primarily internally at this stage, so we aim to create a one-color wordmark that embodies the company's essence, identity, and values. By utilizing a clean and minimalist design approach, we will craft a logo that resonates with the target audience, conveying a sense of professionalism and reliability.

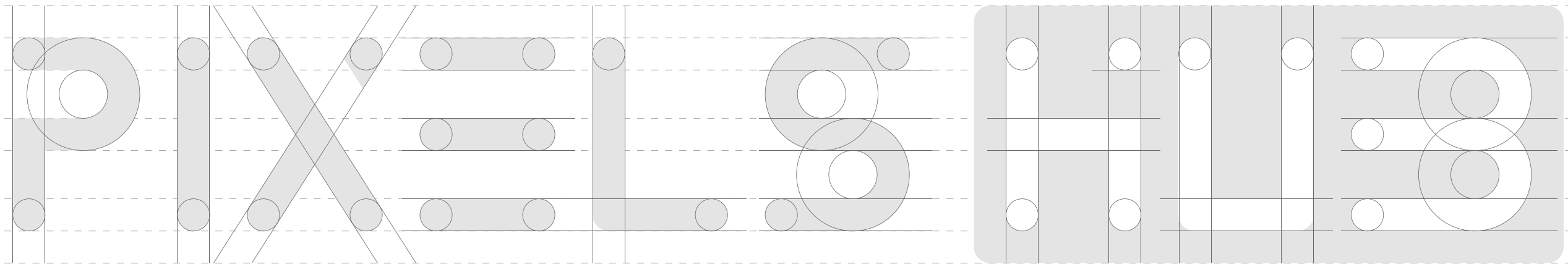

THE PRIMARY COLOR

EXCITEMENT | ENERGY | PASSION



PIXELS HUB

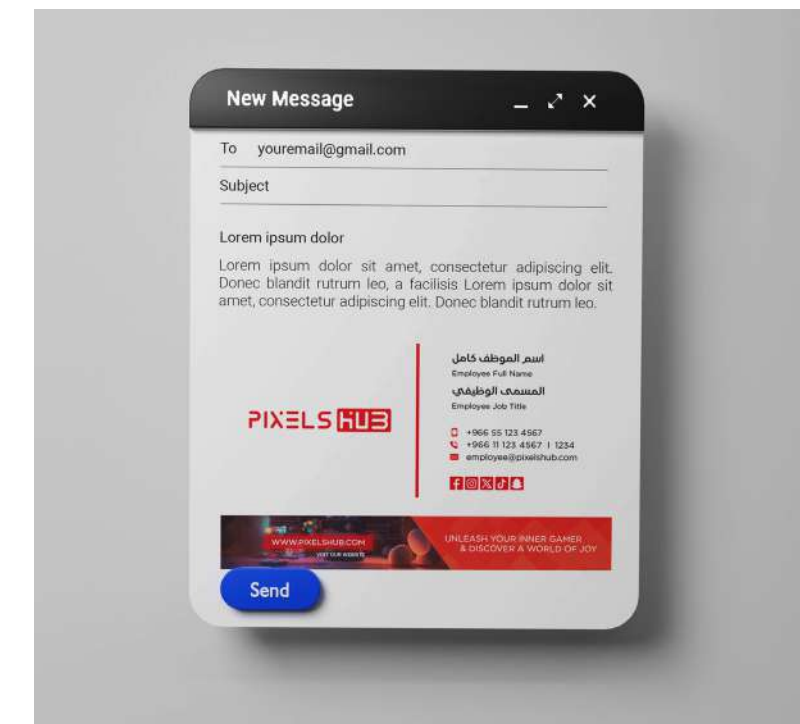

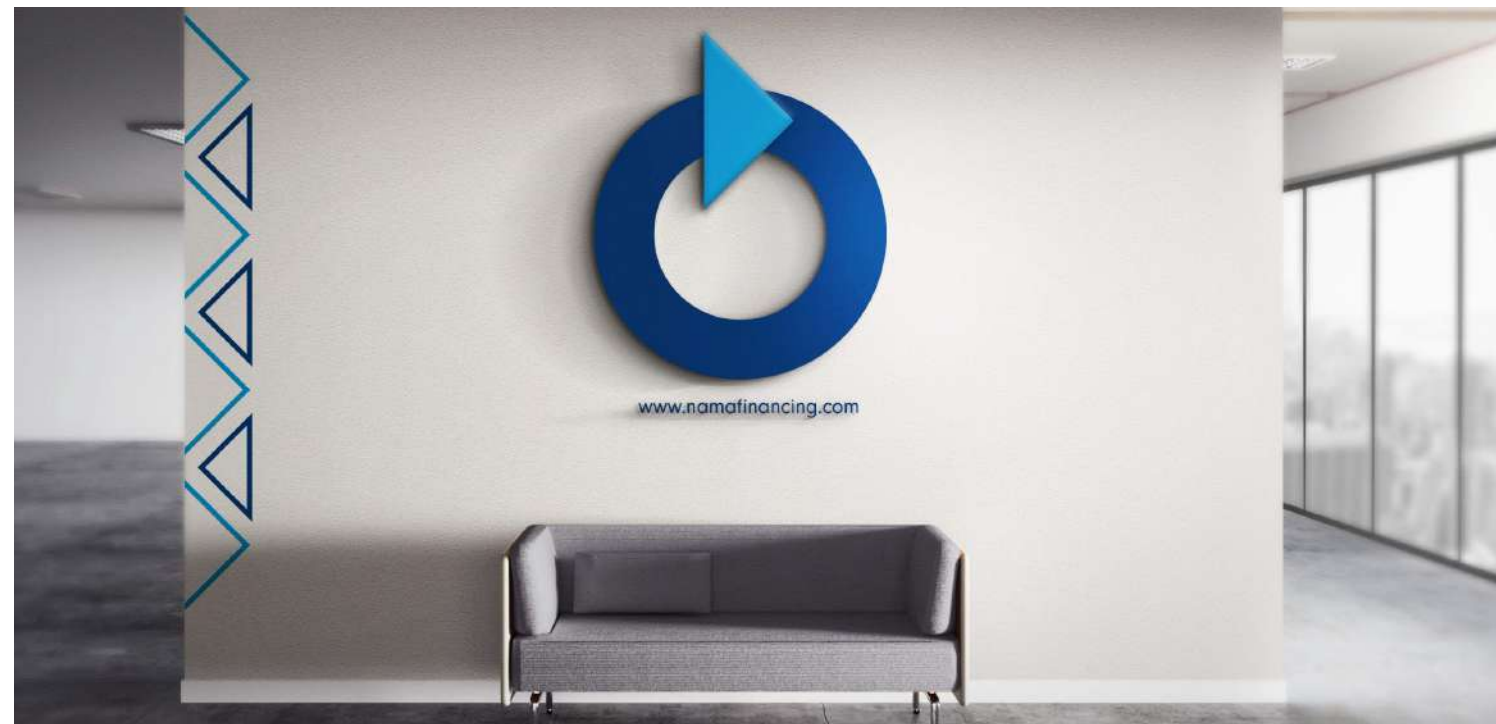

PANTONE | 281C
#003876

CMYK: 100 | 72 | 0 | 38
RGB: 0 | 56 | 118

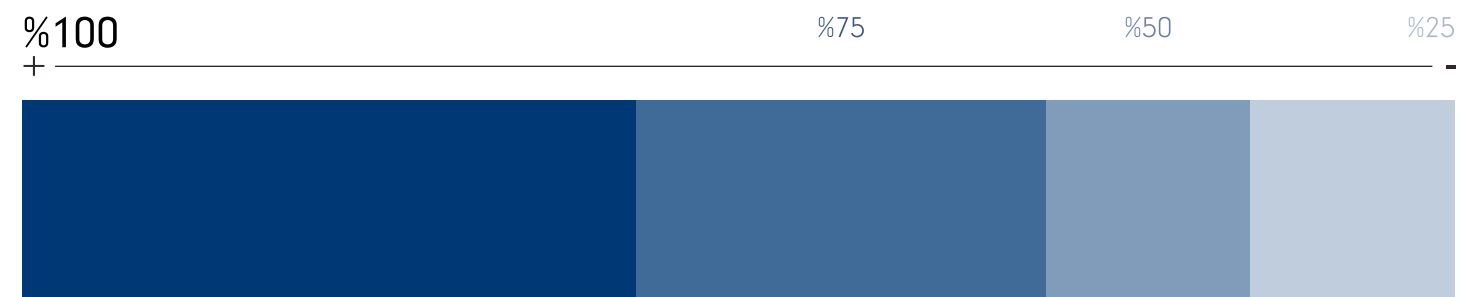

ROYAL BLUE

deep, rich color that conveys trust, confidence, and security. It is a popular choice for financial brands because it is associated with stability and reliability.



Aa	Bb	Cc	Dd	Ee	Ff	Gg	Hh	Ii
Jj	Kk	Ll	Mm	Nn	Oo	Pp	Qq	Rr
Ss	Tt	Uu	Vv	Ww	Xx	Yy	Zz	
01	02	03	04	05	06	07	08	09
!!	??	##	\$\$	%%	&&	++	@	

Neuzeit Grotesk
LIGHT | REGULAR | BOLD | BLACK

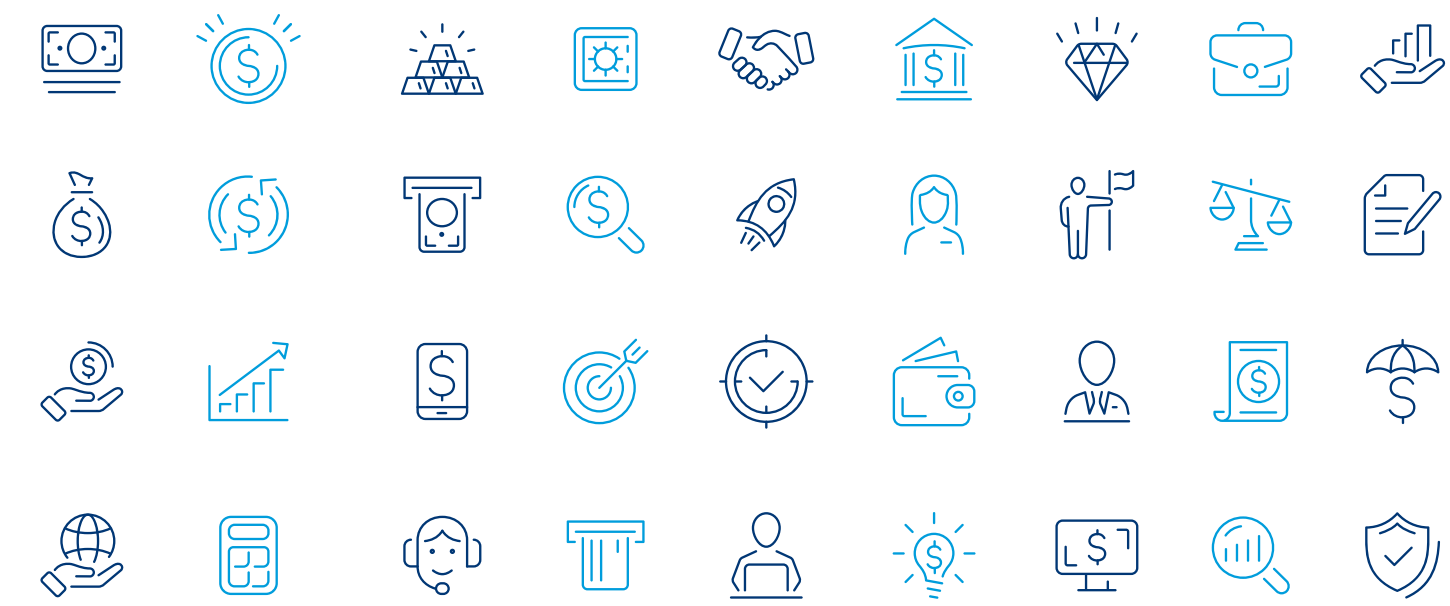





PANTONE 5483 C

#59848D

R: 89 | G: 132 | B: 141

C: 71 | M: 30 | Y: 37 | K: 12



MESILA
— HOLDING —

OMACO BRAND GUIDELINES

WWW.OMACO.COM

INTRODUCTION

At the core which we stand together, please. All the faces, and the order matters. It also all these elements a substantial approach to the brand.

OMACO maintenance and making sure for the use of the brand mark and symbols.



OMACO's visual communication includes in order to maintain the brand. It also all these elements a substantial approach to the brand.

PHYSICAL STYLE

role in the OMACO website and author, icons primary role is to guide a visitor or a content.

the vector files of the icons. They have been all stroke weights and be of equal proportions



SECONDARY COLORS

Our secondary brand colors complement our primary



OMACO PERSONALITY

OMACO STATIONERY



OMACO اومكو

PRIMARY COLORS

MSU GREEN is our leading brand color, highlighted with BROWN SUGAR.

#104735
MSU GREEN

#8B4513
BROWN SUGAR



WHITE SPACE



White space is an integral part of any brand identity. The correct use of white space, margins, gutters, padding, and alignment, is essential for a clean, professional, and readable design.

OMACO
اومكو

ENGLISH TYPEFACE

Abcd

Montserrat | Bold
ABCDEFGHIJKLMNOPQRSTUVWXYZ
abcdefghijklmnopqrstuvwxyz
1234567890@!#\$%^&*~

Abcd

Montserrat | Medium
ABCDEFGHIJKLMNOPQRSTUVWXYZ
abcdefghijklmnopqrstuvwxyz
1234567890@!#\$%^&*~

TYPESSETTING

Headline

Allowed to use Bold in larger font sizes.

Subtitle

Allowed to use in Bold in the last line.

Body Text

Body text must be in the last line.



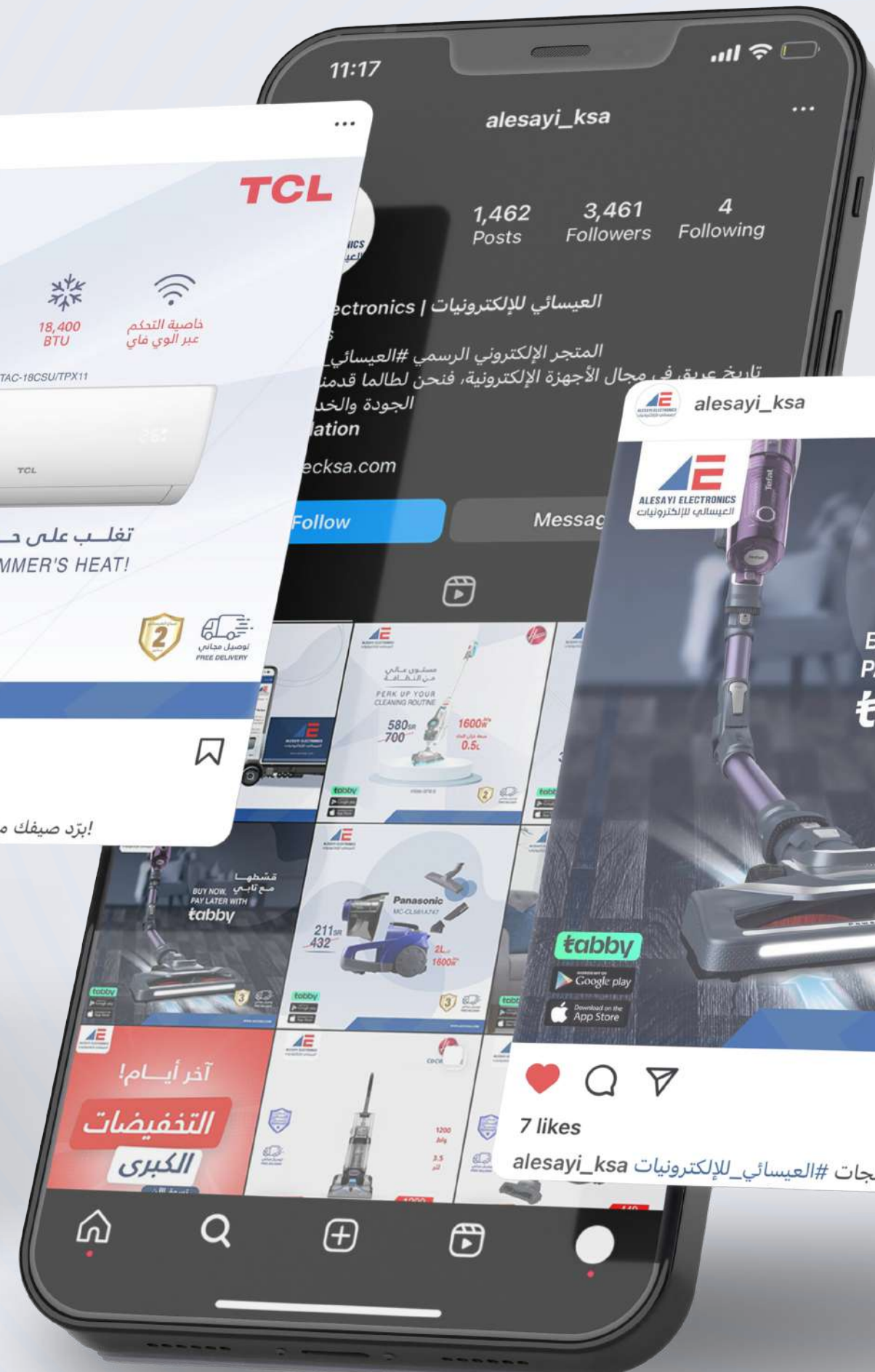
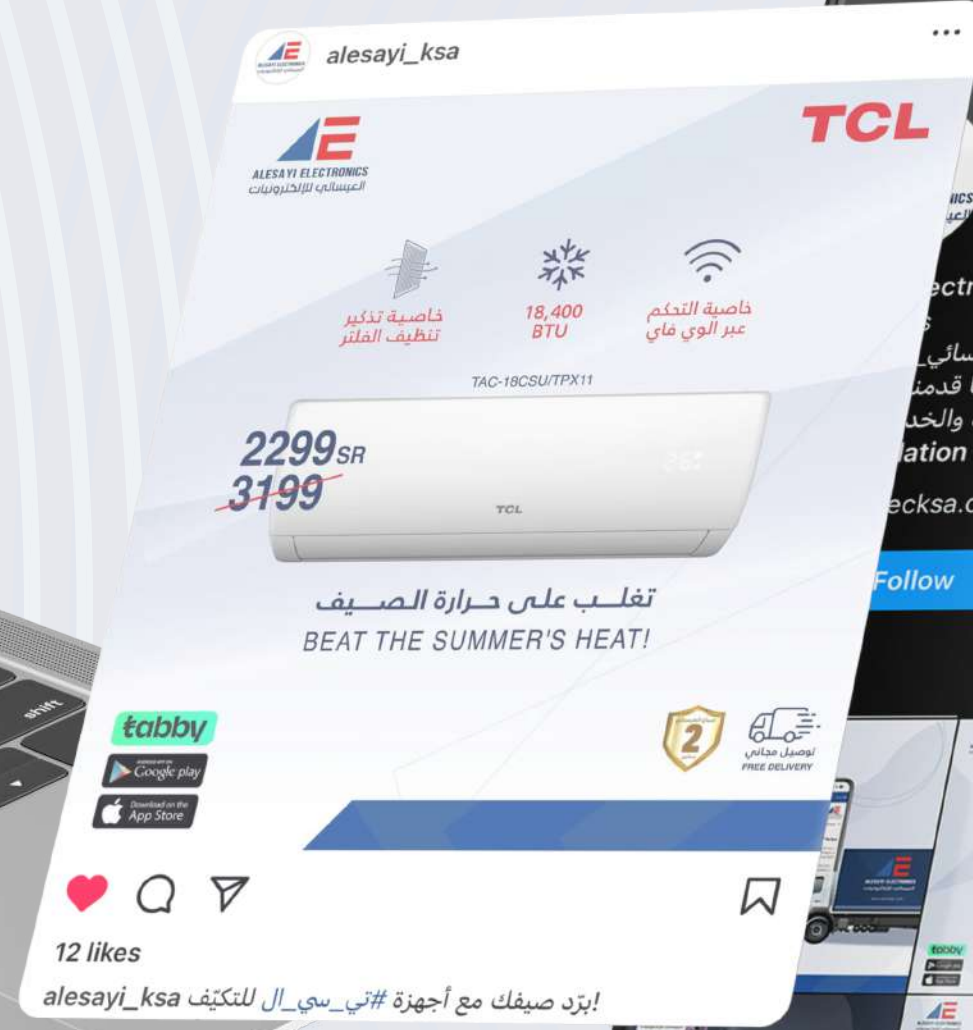
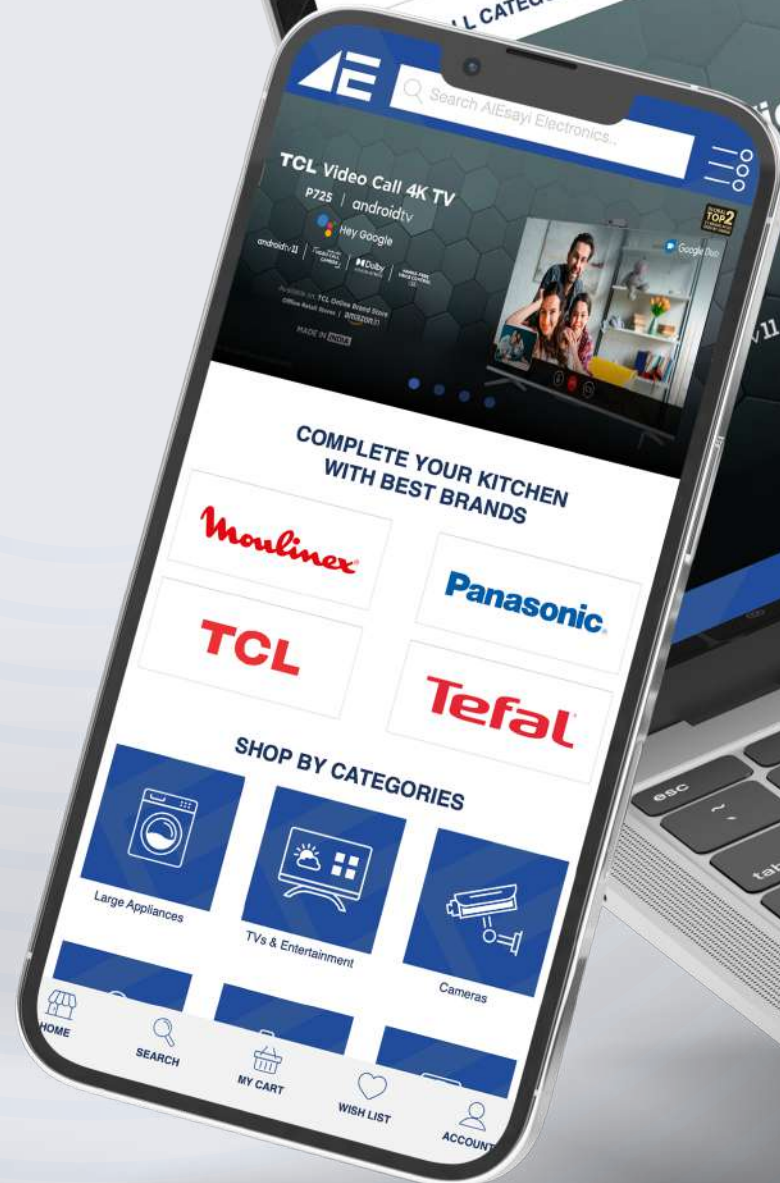
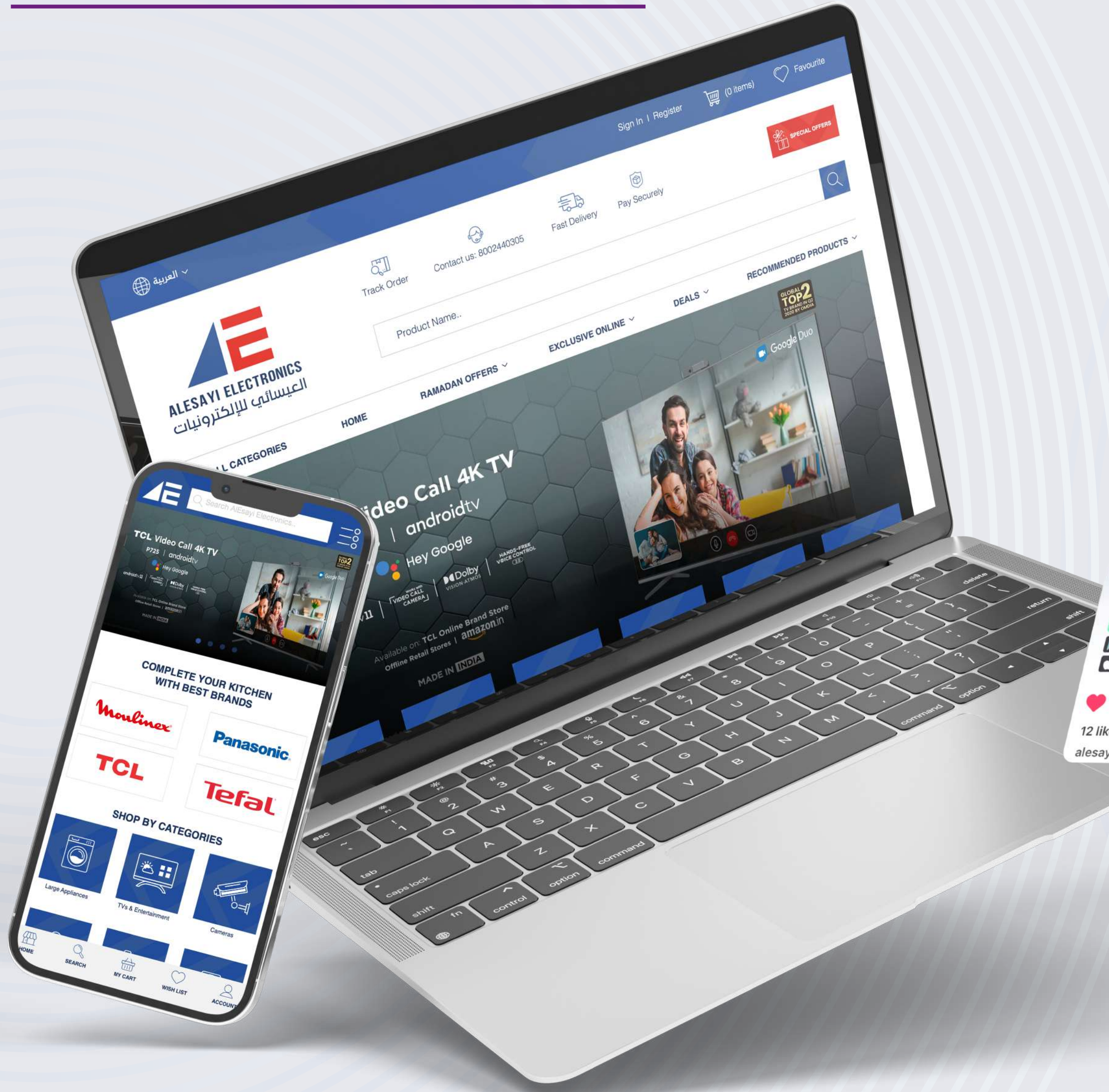

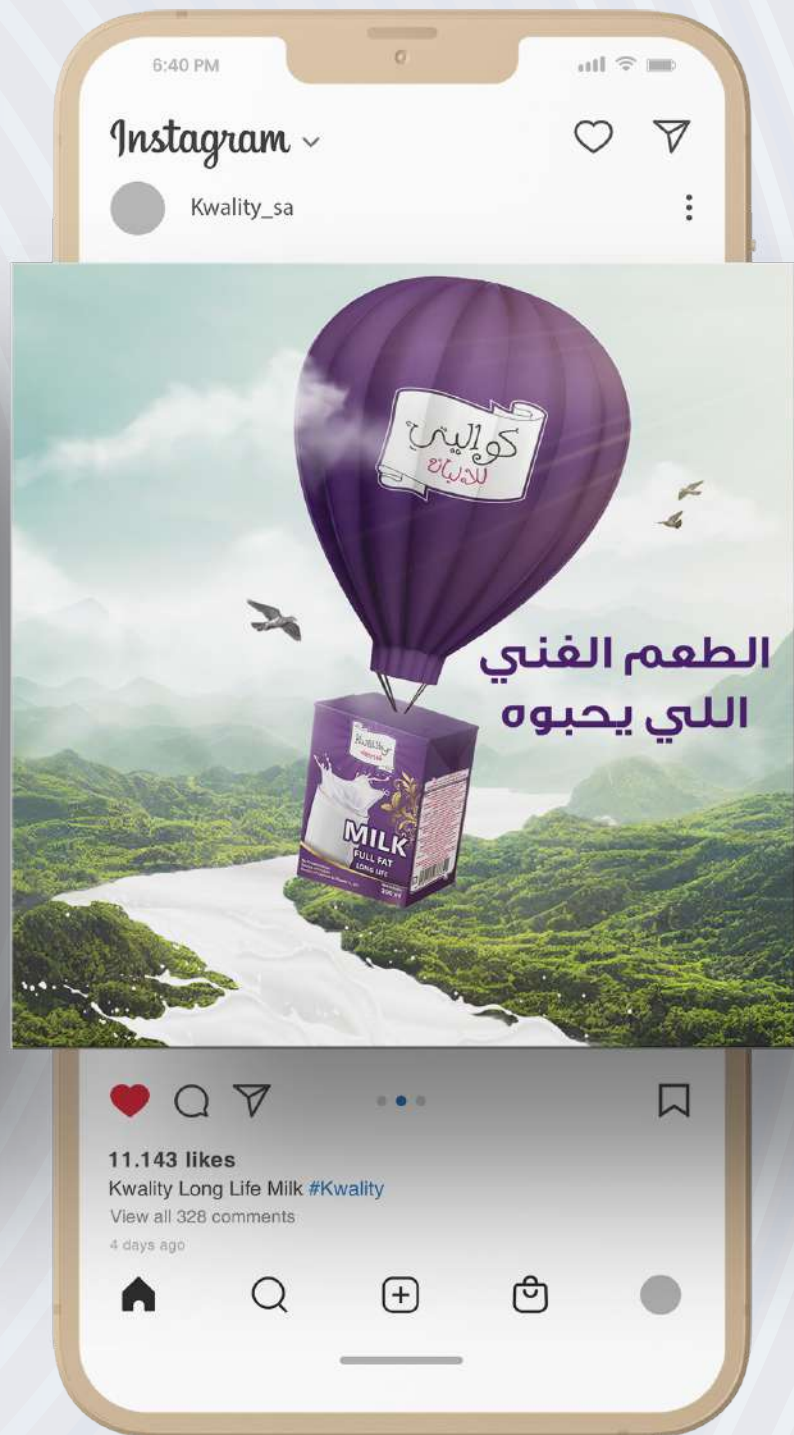



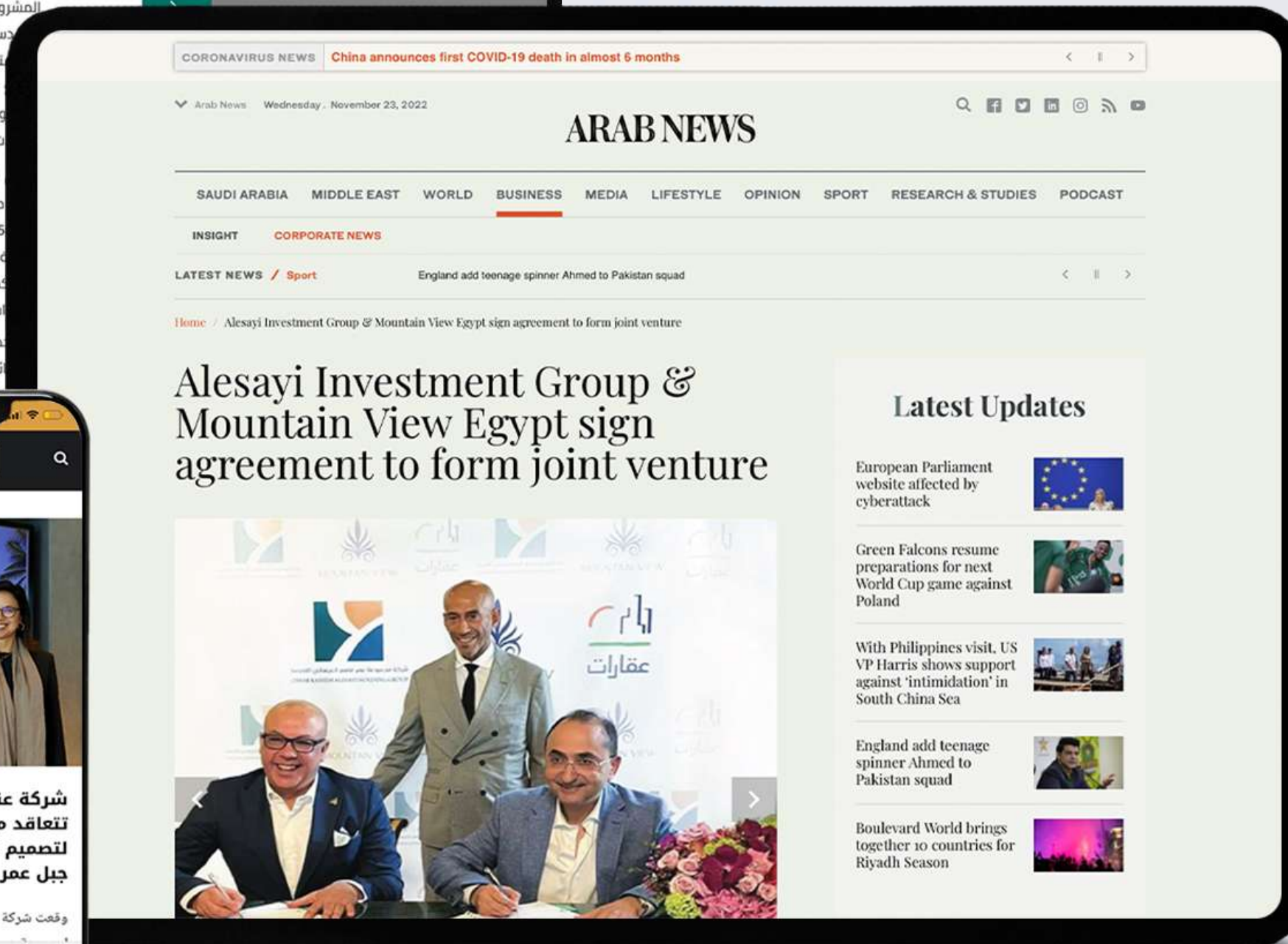
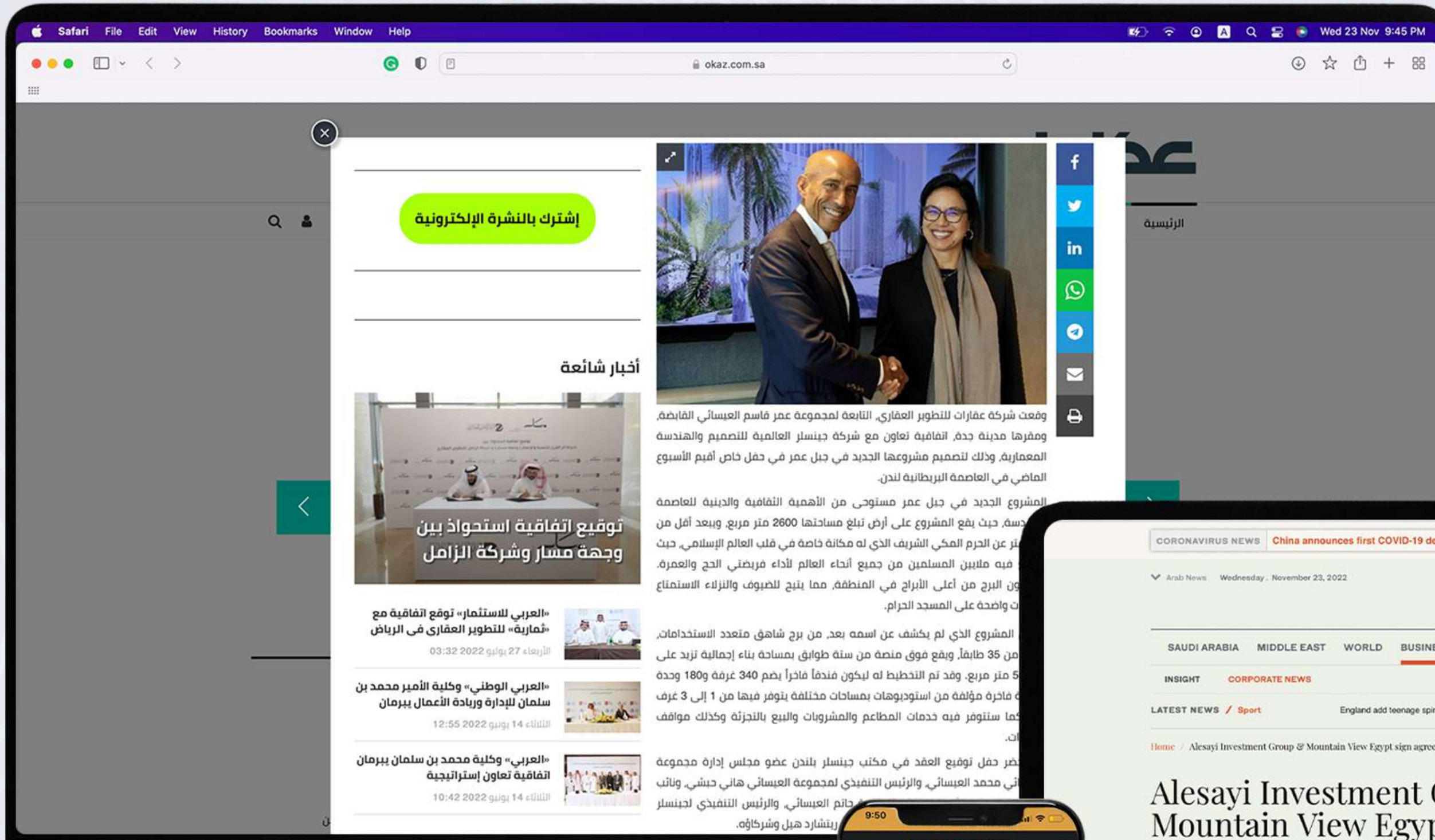

عكاكز
O K A Z

الرياض

التشرق الأوسط

ARAB NEWS

Saudi Gazette

AL-JAZIRAH
الجazeera

اليوم





CREVERSE



COPYRIGHT © CREVERSE KSA - ALL RIGHTS RESERVED

SHOWS & IMMERSIVE EXPERIENCE



CREVERSE

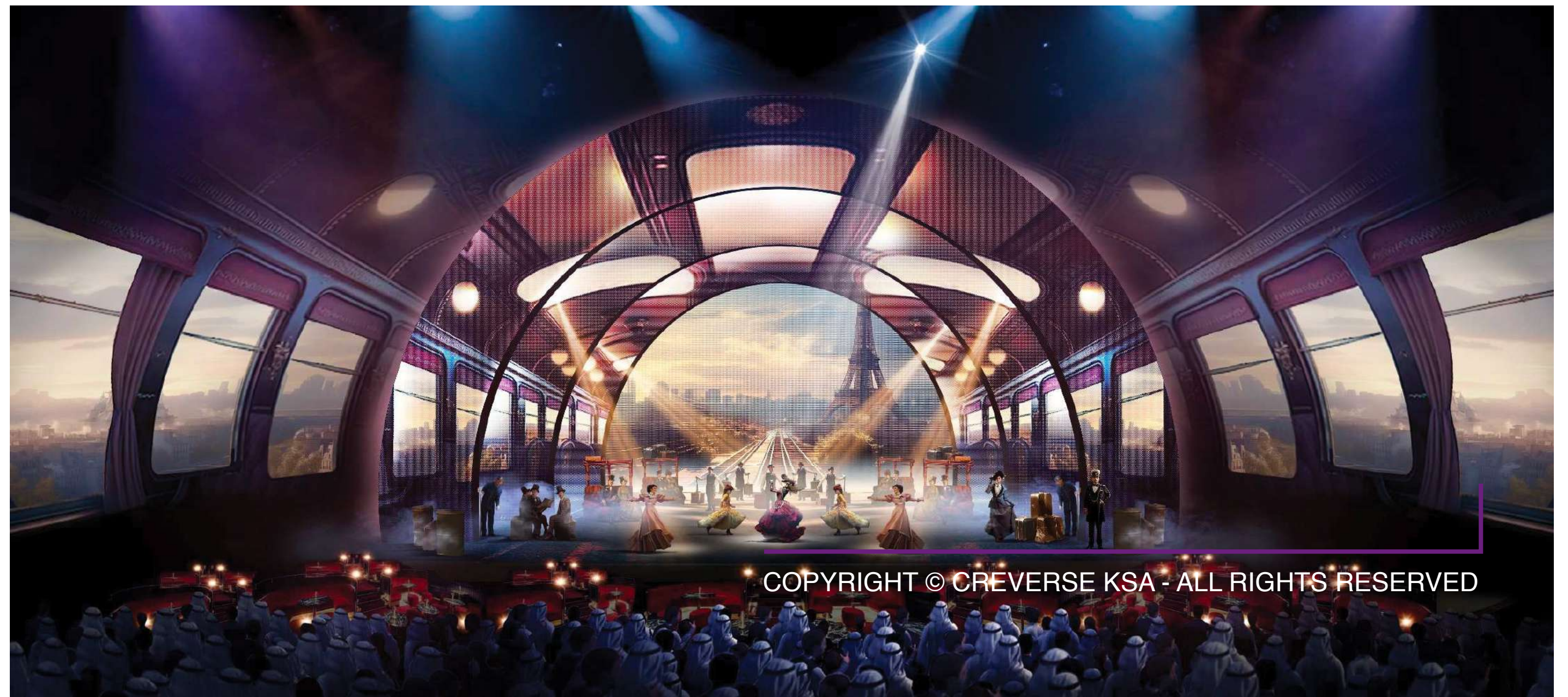
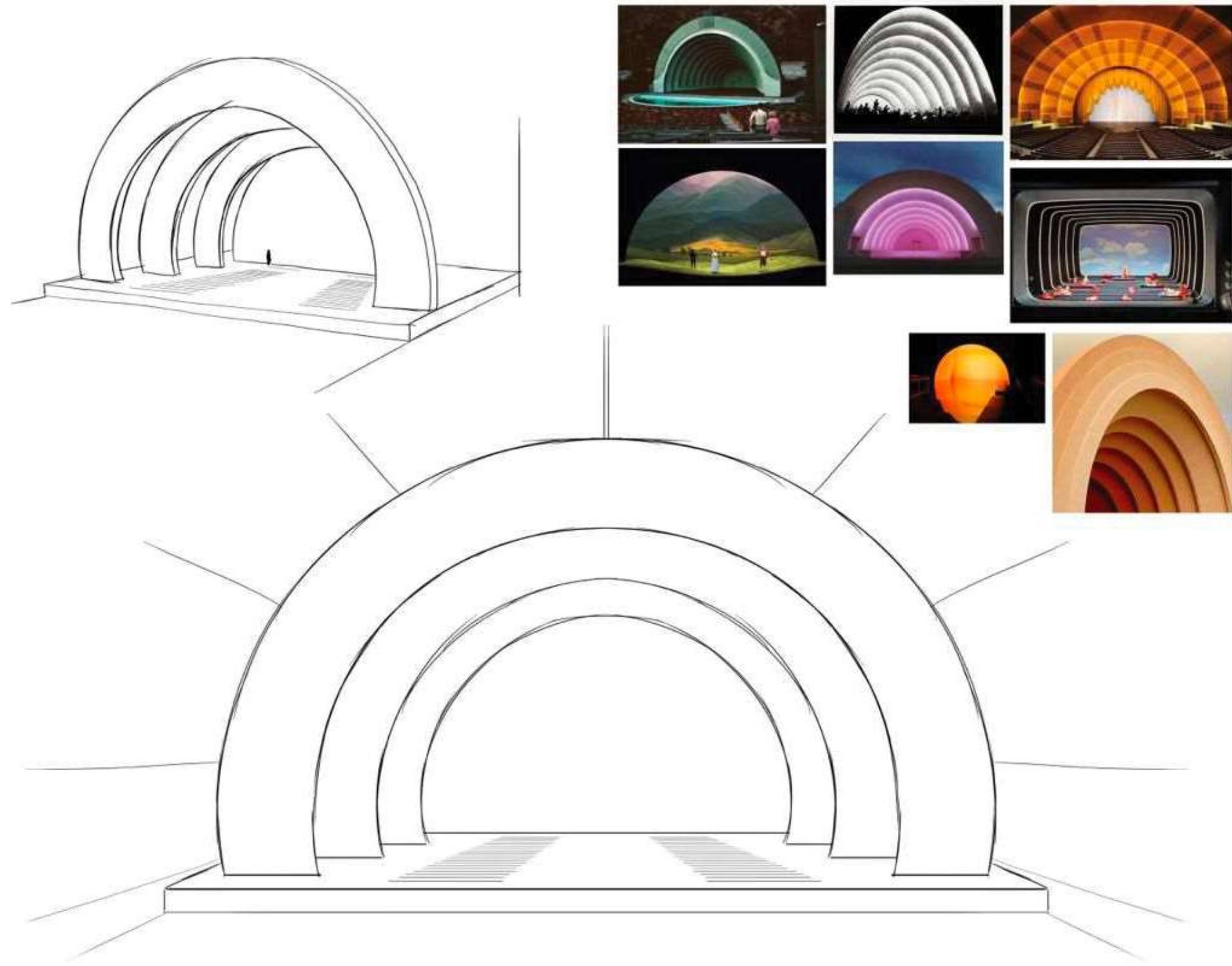

LIVE PERFORMANCE EXPERIENCE WHILE WAITING FOR THE SHOW TO START

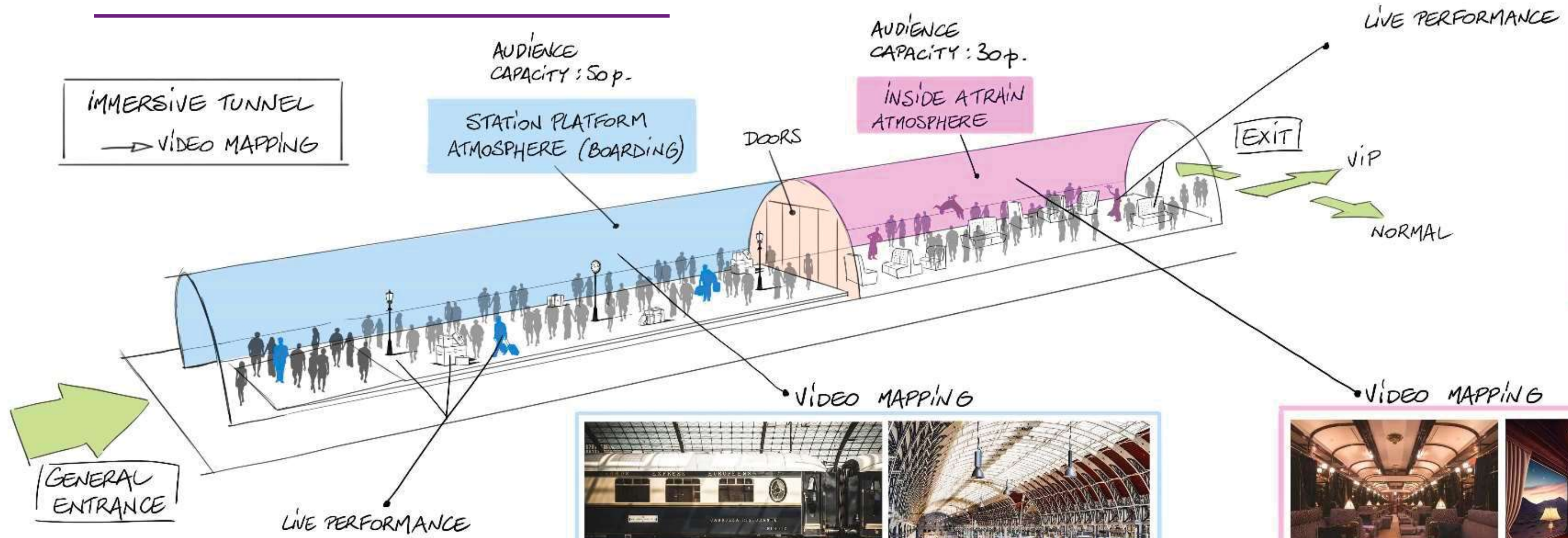

REFERENCES :



STATION ATMOSPHERE



CREVERSE

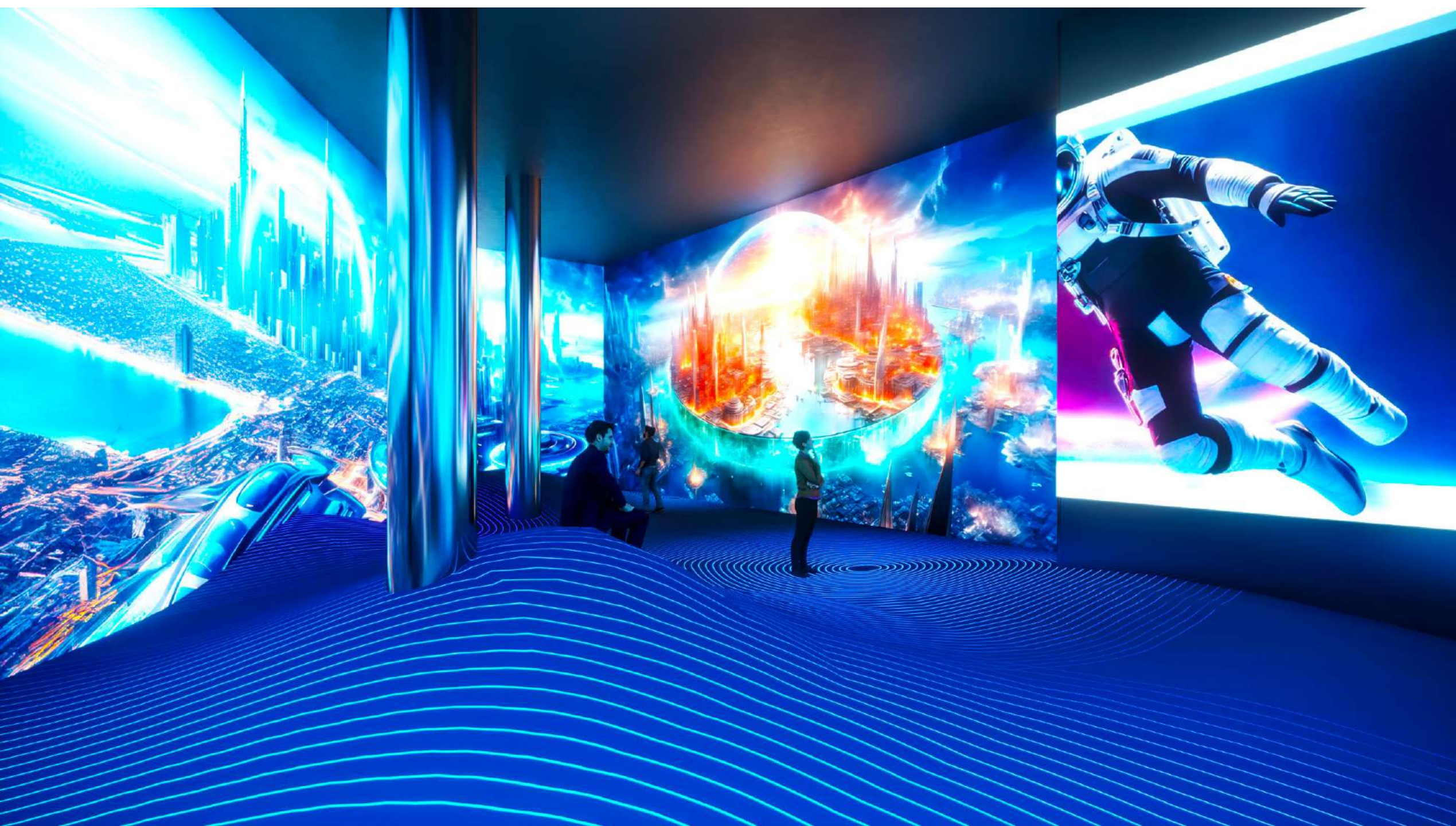
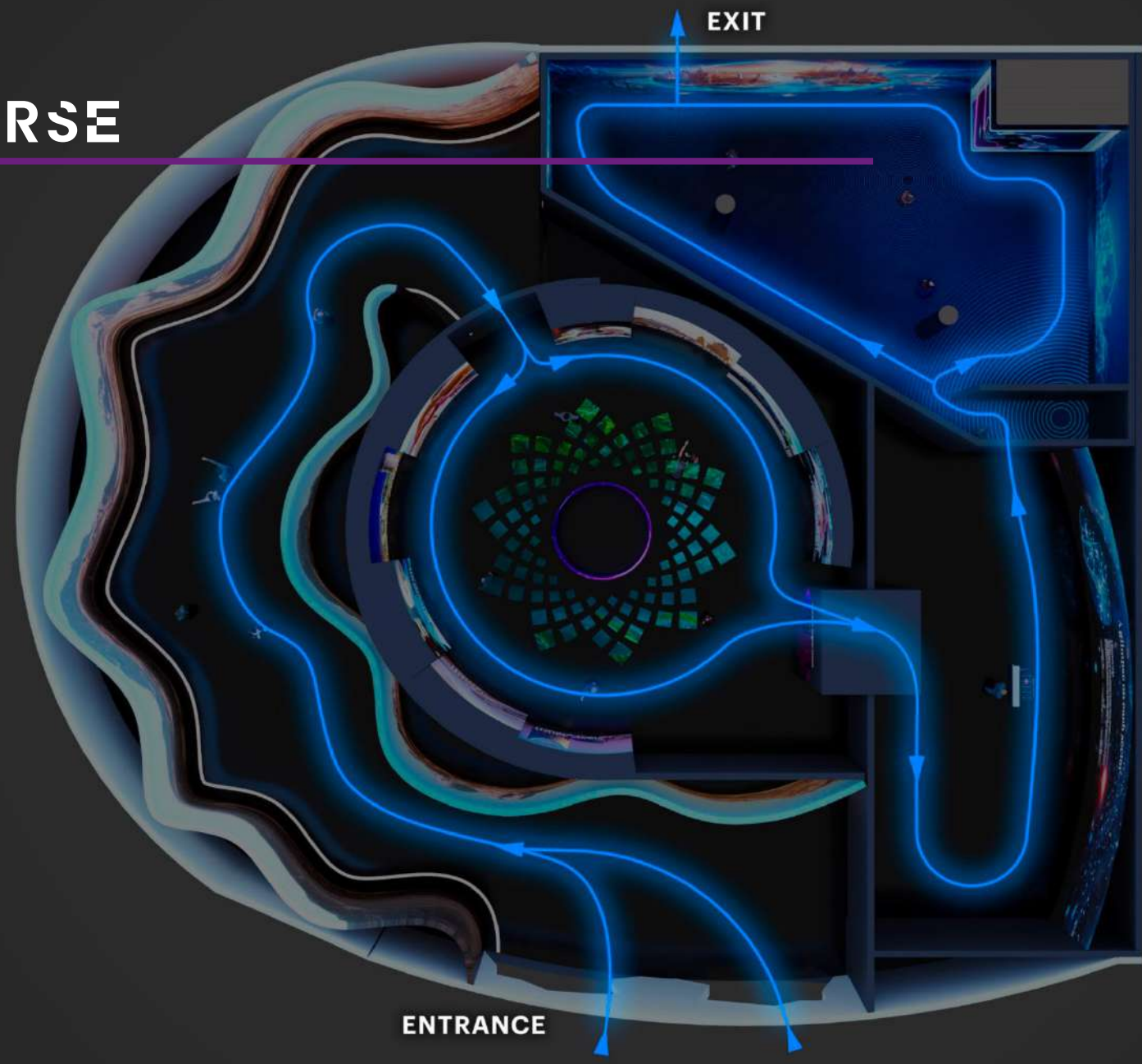

COPYRIGHT © CREVERSE KSA - ALL RIGHTS RESERVED

CREVERSE



A GLIMPSE ON EACH SECTOR



Chemicals
Overview
Saudi Arabia is a top global destination for large chemical plants, as well as downstream value chain partners such as specialty chemicals, conversion, engineering plastics, and rubber @saudia.com.
Saudi Arabia is home to one of the most advanced chemical production facilities in the world, thanks to decades of cumulative investment in the chemicals sector, the production of chemical products across all segments.

97,267 - KT
chemical production capacity in KTA for 2017

5 - %
production growth for 2016

170 - BN
operating revenues of the Chemicals sector for 2016

A glimpse on each sector



Chemicals

Overview
Saudi Arabia is a top global destination for large chemical companies, as well as downstream value chain partners such as specialty chemicals, conversion, engineering plastics, and rubber @saudia.com.
Saudi Arabia is home to one of the most advanced chemicals industries globally. Thanks to decades of cumulative investment in the chemicals sector, Saudi Arabia is a global leader in the production of chemical products across all segments – basic, intermediate, and specialty.

97,267 - KT
chemical production capacity in KTA for 2017

5 - %
production growth for 2016

170 - BN
operating revenues of the Chemicals sector for 2016

Kingdom OF TOMORROW
PIF



COPYRIGHT © CREVERSE KSA - ALL RIGHTS RESERVED

CREVERSE



COPYRIGHT © CREVERSE KSA - ALL RIGHTS RESERVED

CREVERSE

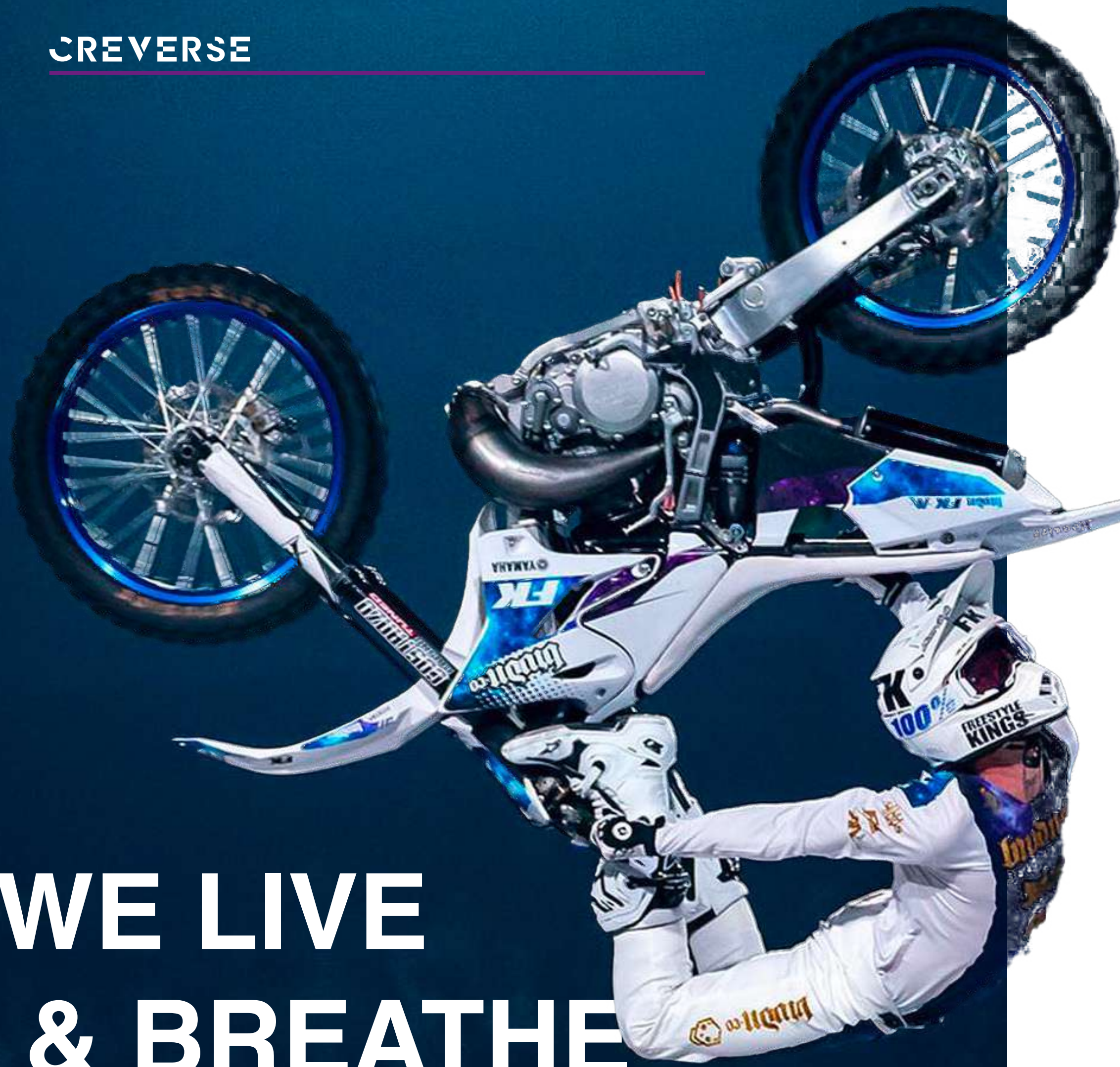

WE LIVE
& BREATHE
FREESTYLE MOTOCROSS!



COPYRIGHT © CREVERSE KSA - ALL RIGHTS RESERVED

CREVERSE

KVANTY
POZNÁNÍ
ZÁBAVA

Děkujeme za návštěvu
 a vřelý pozdrav z našeho
 centra. Za nás pracují
 odborníci z oblasti
 fyziky a matematiky, kteří
 vám poskytnou všechny
 informace a pomohou
 pochopit základy
 kvantové fyziky.
 Vítejte v našem světě
 kvantové fyziky.



byl vynalezen v roce 1947 v USA. Systém je určen k měření rychlosti a směru pohybu těles.

Operační systém je určen k měření rychlosti a směru pohybu těles.

CREVERSE



COPYRIGHT © CREVERSE KSA - ALL RIGHTS RESERVED

CREVERSE



COPYRIGHT © CREVERSE KSA - ALL RIGHTS RESERVED

CREVERSE

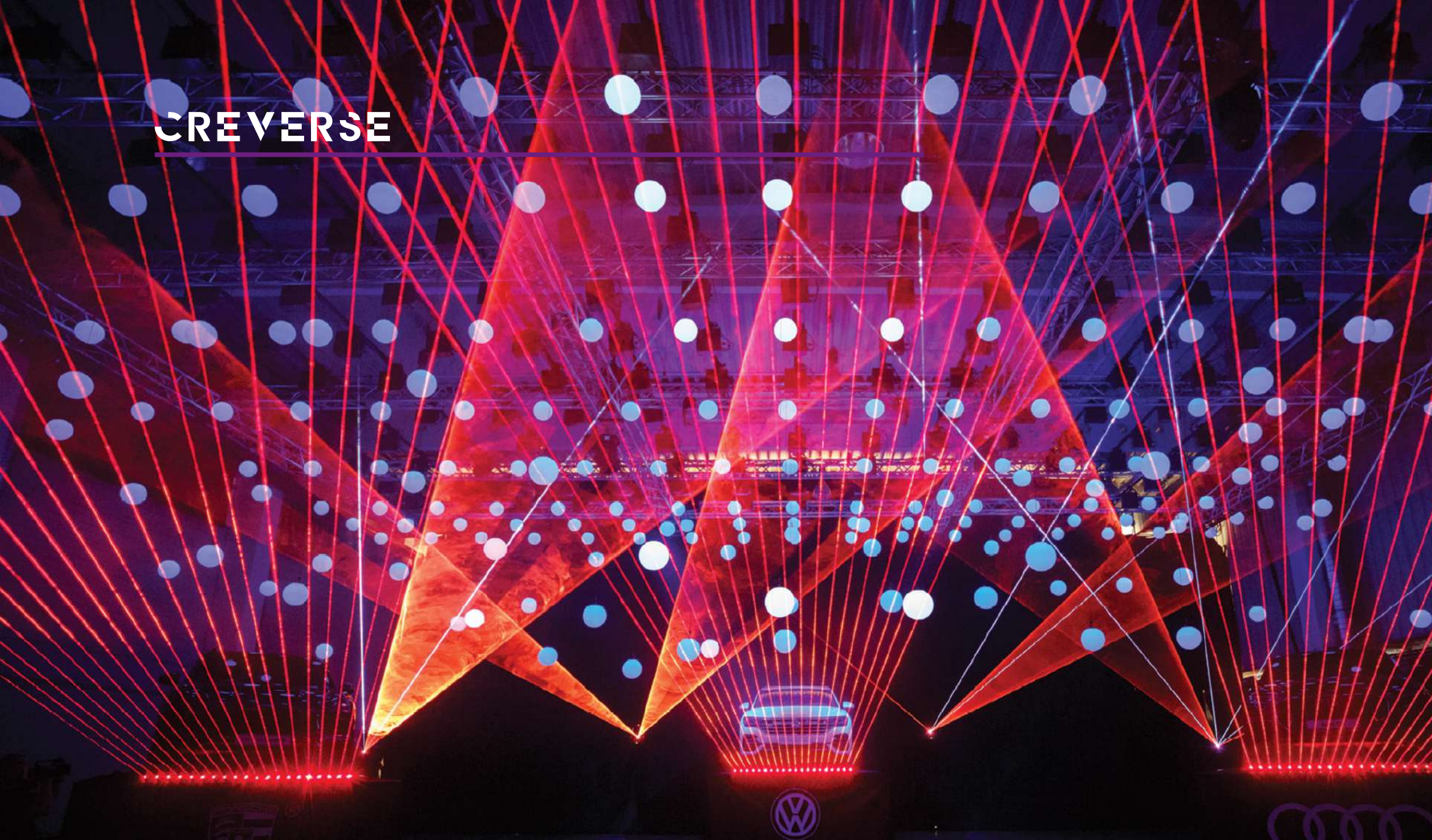

COPYRIGHT © CREVERSE KSA - ALL RIGHTS RESERVED

CREVERSE



COPYRIGHT © CREVERSE KSA - ALL RIGHTS RESERVED

CORPORATE EVENTS





CREVERSE





COPYRIGHT © CREVERSE KSA - ALL RIGHTS RESERVED



PRODUCTION & POS MATERIAL

CREVERSE

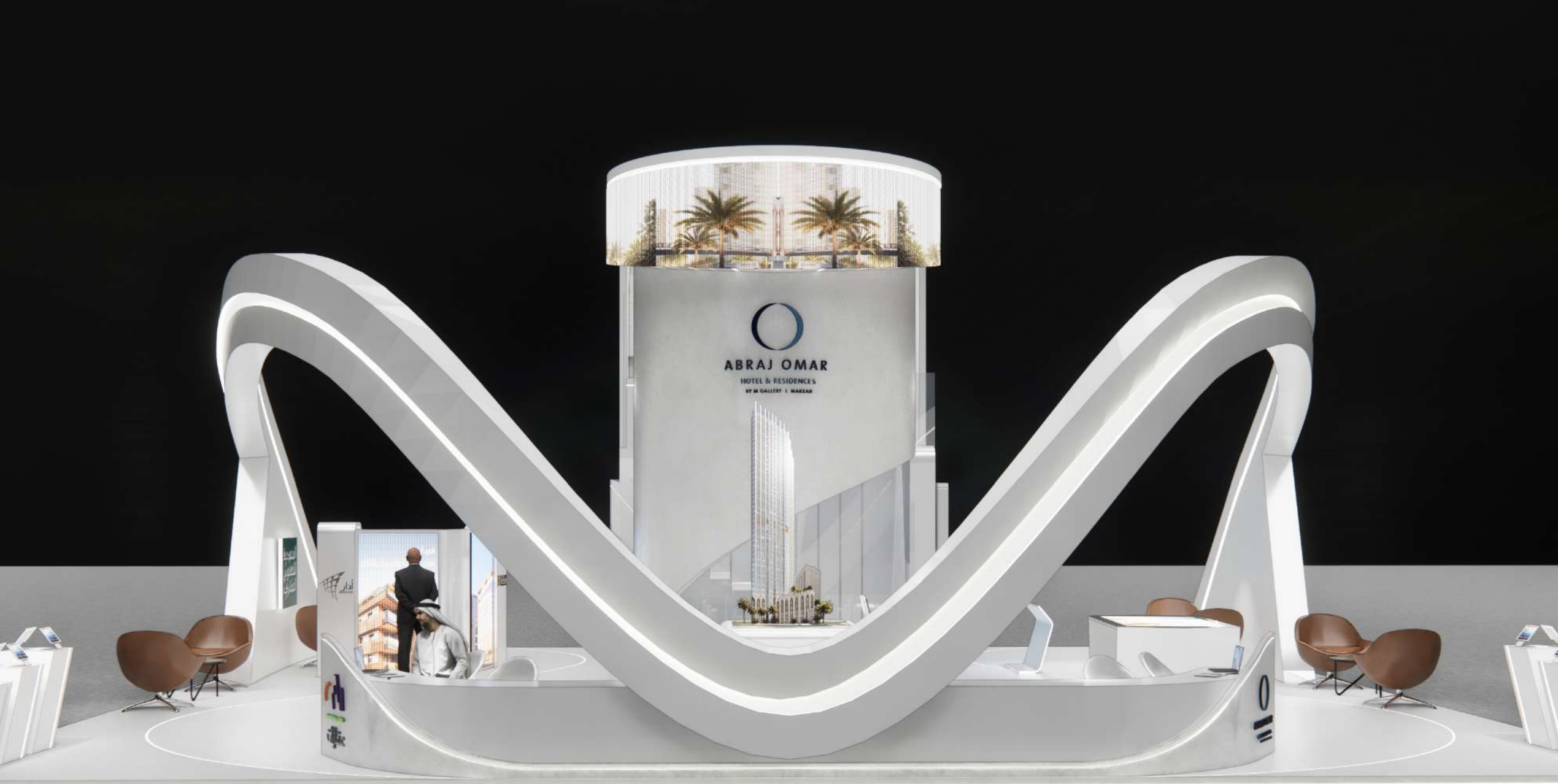

COPYRIGHT © CREVERSE KSA - ALL RIGHTS RESERVED

CREVERSE

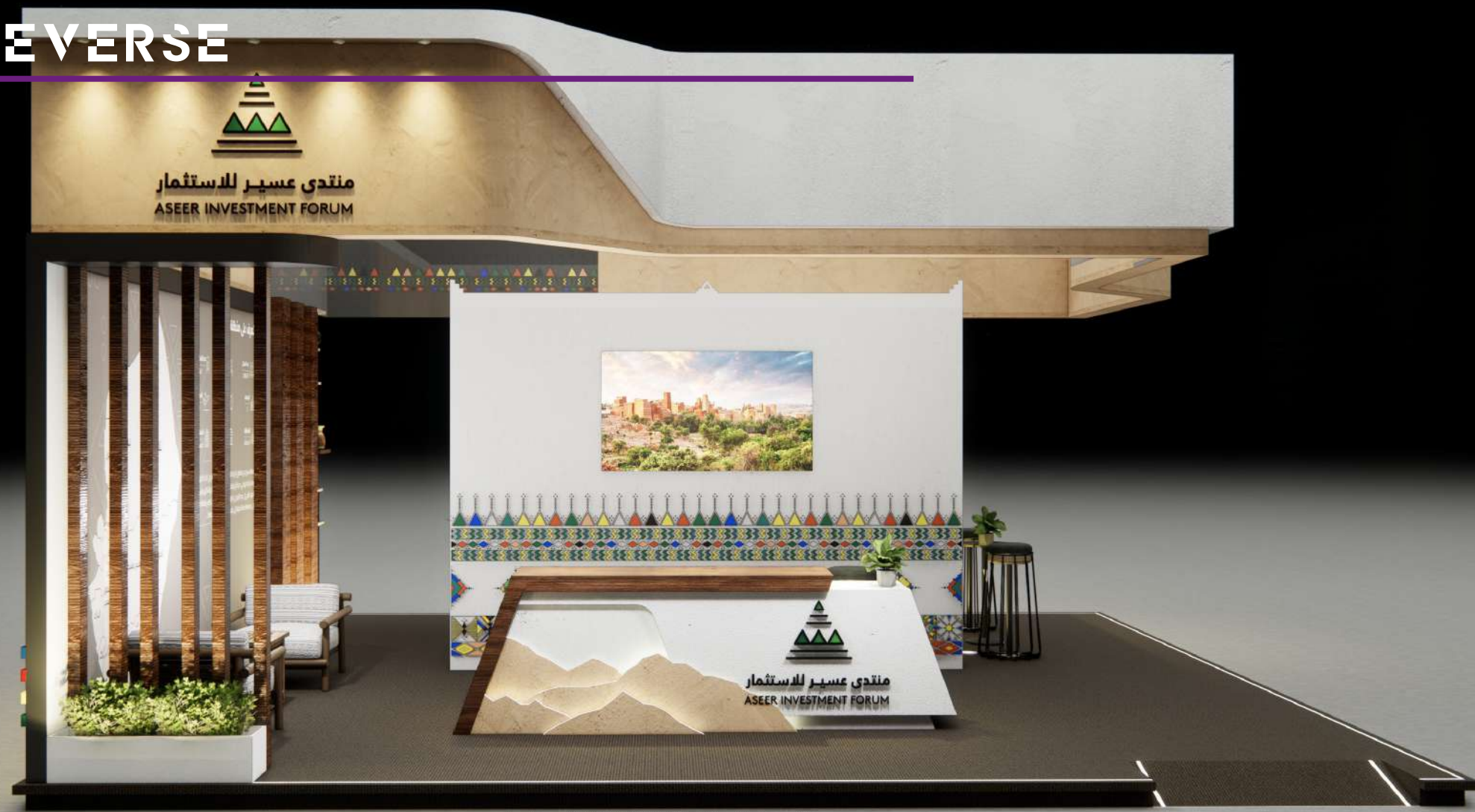

COPYRIGHT © CREVERSE-KSA - ALL RIGHTS RESERVED



CREVERSE

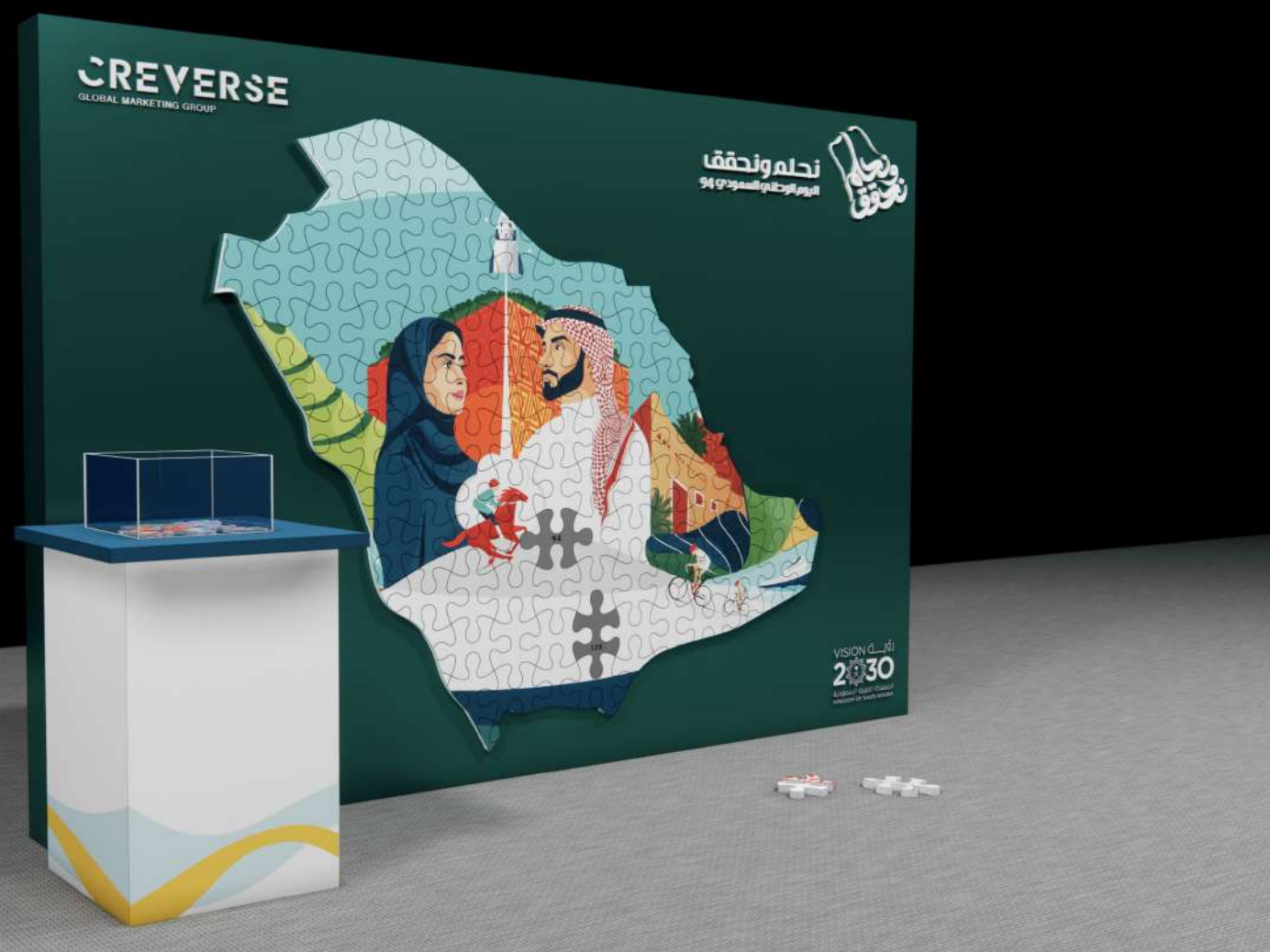

COPYRIGHT © CREVERSE KSA - ALL RIGHTS RESERVED

CREVERSE

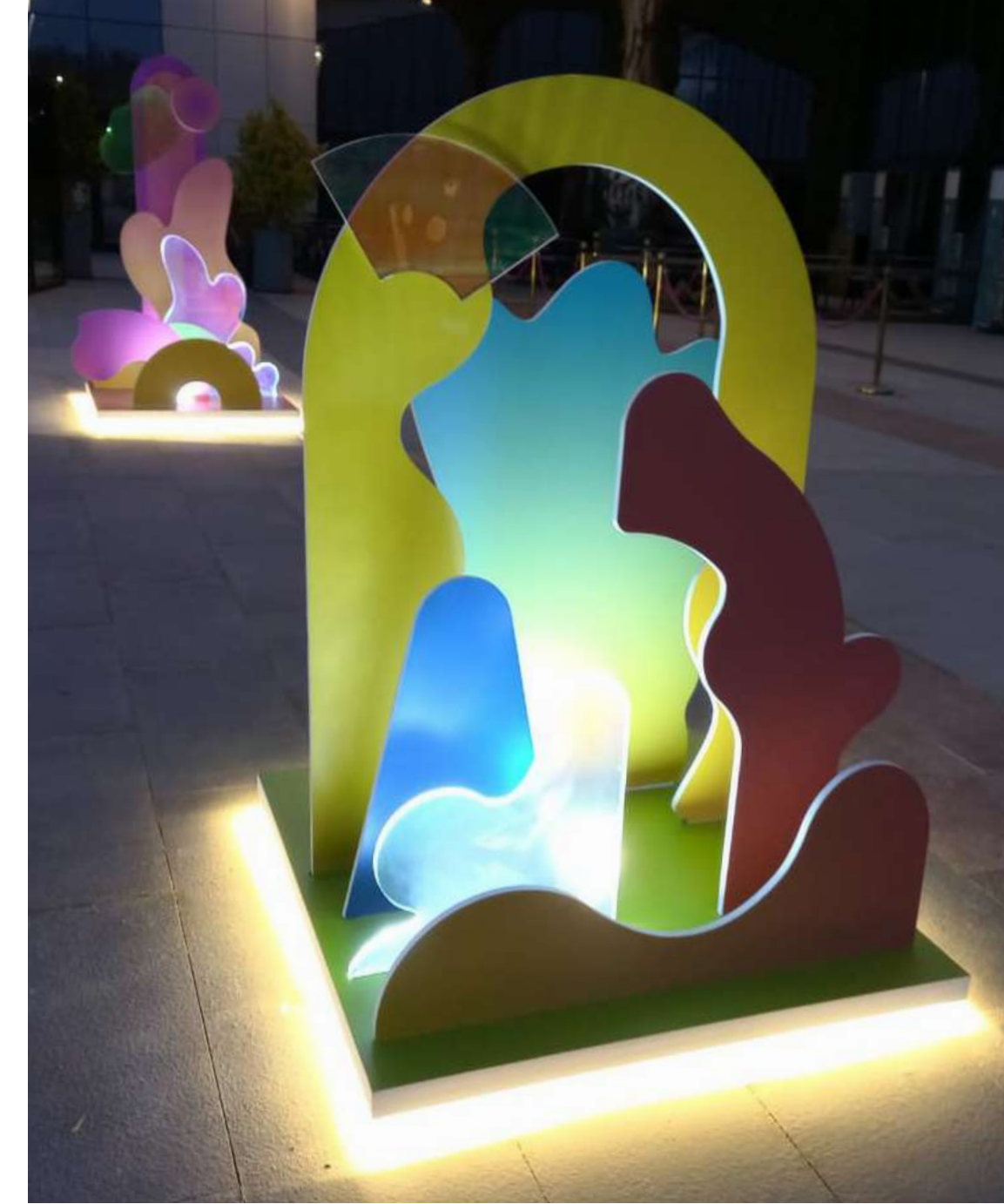

COPYRIGHT © CREVERSE KSA - ALL RIGHTS RESERVED

CREVERSE



COPYRIGHT © CREVERSE KSA. ALL RIGHTS RESERVED



CREVERSE



COPYRIGHT © CREVERSE KSA - ALL RIGHTS RESERVED

CREVERSE



COPYRIGHT © CREVERSE KSA - ALL RIGHTS RESERVED



CREVERSE



COPYRIGHT © CREVERSE KSA - ALL RIGHTS RESERVED

THANK YOU



CREVERSEKSA

